



MURRAY HILL, NEW YORK CITY

NATIONAL REGISTER OF HISTORIC PLACES, HISTORIC DISTRICTS AND LANDMARKS

Expanded National Register
Boundary, 2013

Murray Hill Historic District
and National Register, 2003

Murray Hill Historic
District,
Local (NYC), 2002

Proposed Landmarks
4/10/2016

Sniffen Court National
and Local Historic
Districts, 1966

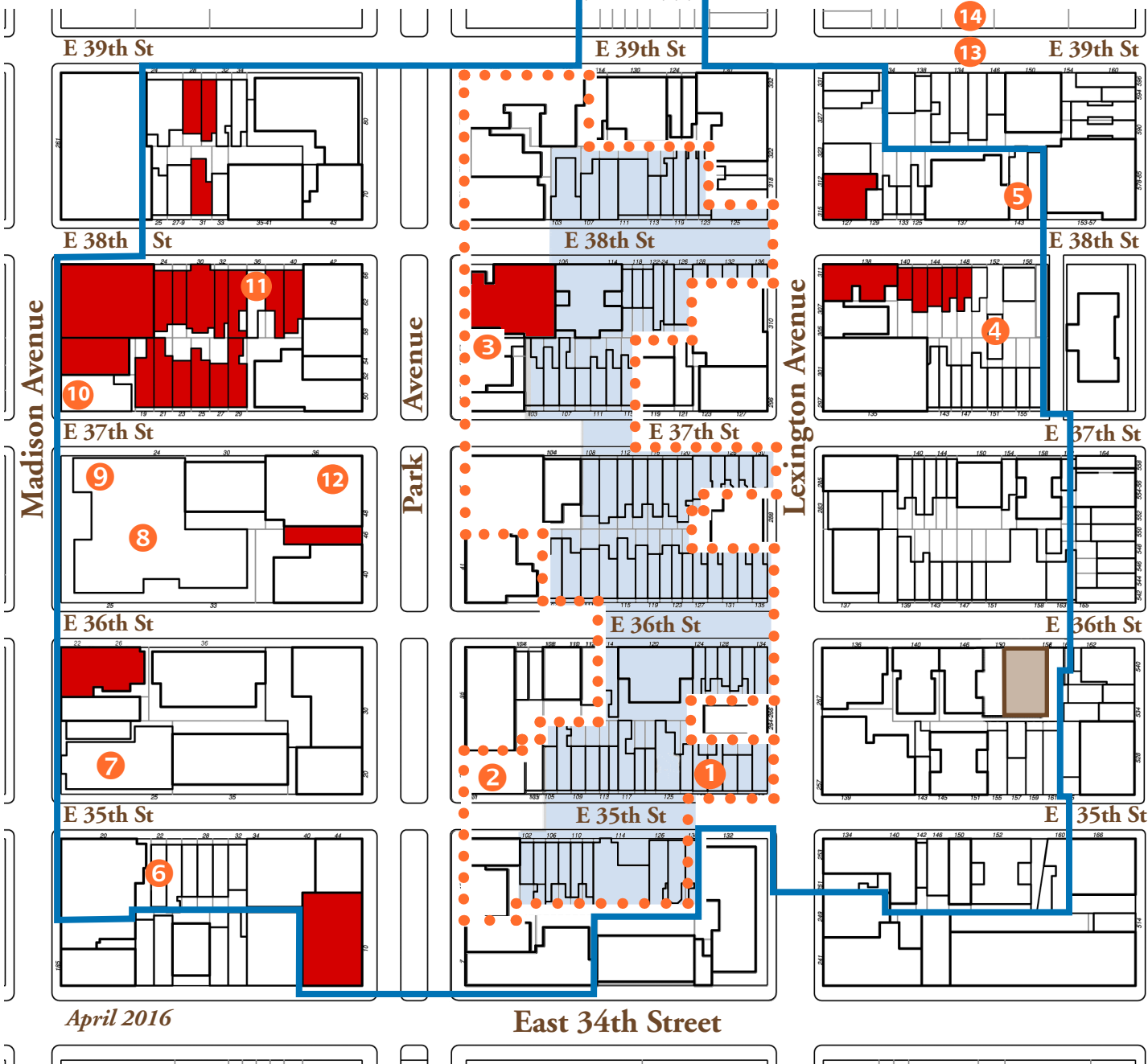

INDIVIDUAL LANDMARKED BUILDINGS

Bold numbers following the descriptions refer to the MHNA Walking Tour Map. To purchase a copy of the Tour Map, call **212-886-5867**.

- 1** James and Harriet Lanier House (1901)
123 East 35th Street
Architects: Hoppin & Koen. #16
- 2** James Hampden Robb and Cornelia Van Rensselaer Robb House (1888)
23 Park Avenue at 35th Street
Architect: Stanford White. #14
- 3** Adelaide Douglas House (1909), former U.S. Olympic House, now the Guatemalan Permanent Mission to the UN
57 Park Avenue
Architect: Horace Trumbauer. #45
- 4** Federal Style home (1857) once part of Martin Van Buren family member estate, converted to Regency Style House in 1934
152 East 38th Street #29
- 5** George S. Bowdoin Stable (1902)
149 East 38th Street
Architect: Ralph S. Townsend. #30
- 6** Thomas Clarke House (1901), now the Collectors Club
22 East 35th Street
Architect: Stanford White. #11
- 7** Church of the Incarnation & Rectory (1864)
205, 209 Madison Avenue
Architect: Emlen T. Littell. #10
- 8** Morgan Library & Museum (1902, 2006)
225 Madison Avenue
Architects: McKim, Mead & White, Benjamin W. Morris and Renzo Piano. #7
- 9** J. P. Morgan, Jr. House (1852)
231 Madison Avenue
Architect: R.H. Robertson #6
- 10** Joseph De Lamar House (1902), now the Consulate General of the Republic of Poland
233 Madison Avenue
Architect: C.P.H. Gilbert. #5
- 11** Italianate Brownstone (1847)
36 East 38th Street
New front and rear extension (1902) for Middleton S. Burrill
Architect: Hoppin & Koen. #41
- 12** Union League Club, (1931) Georgian Renaissance Style with symmetrical red brick facade.
38 East 37th Street
Architect: Benjamin Wyster Morris. #2
- 13** Allerton 39th Street House (1916)
Hotel. New front 2012 for Pod Hotel
145 East 39th Street
Architect: Arthur Loomis Hanna
- 14** 148 East 40th St., 1871
Classic Carriage House of salmon brick and white granite with Second Empire ornamental roof and dormers. Builder: Charles E. Hadden. #31

April 2016

East 34th Street