



Henry Gutman, Commissioner

Park Avenue Tunnel

HBM551

Community Boards 5 & 6

Manhattan

October 2021



your city. your needs.
your number.

Important Notice

The NYCDOT Division of Bridges will perform urgent pavement repairs and steel plate replacement at the intersection of Park Avenue and E. 34th Street. *Traffic on the intersection will shift to one lane in each direction as per the graphic below. The southbound Park Ave parking lane will become a travel lane to accommodate construction. Two lanes of traffic will be maintained at all times on Park Ave.* Flaggers will assist with construction related traffic and a temporary walkway will be installed. The work will take place Saturday, October 23 to Saturday, October 30, Monday to Friday 7:00 a.m. to 7:00 p.m.. Saturday and Sunday 5:00 a.m. to 6:00 p.m.

Steel Plate Replacement & Pavement Repairs Park Avenue and East 34th Street Saturday, October 23 through Saturday, October 30

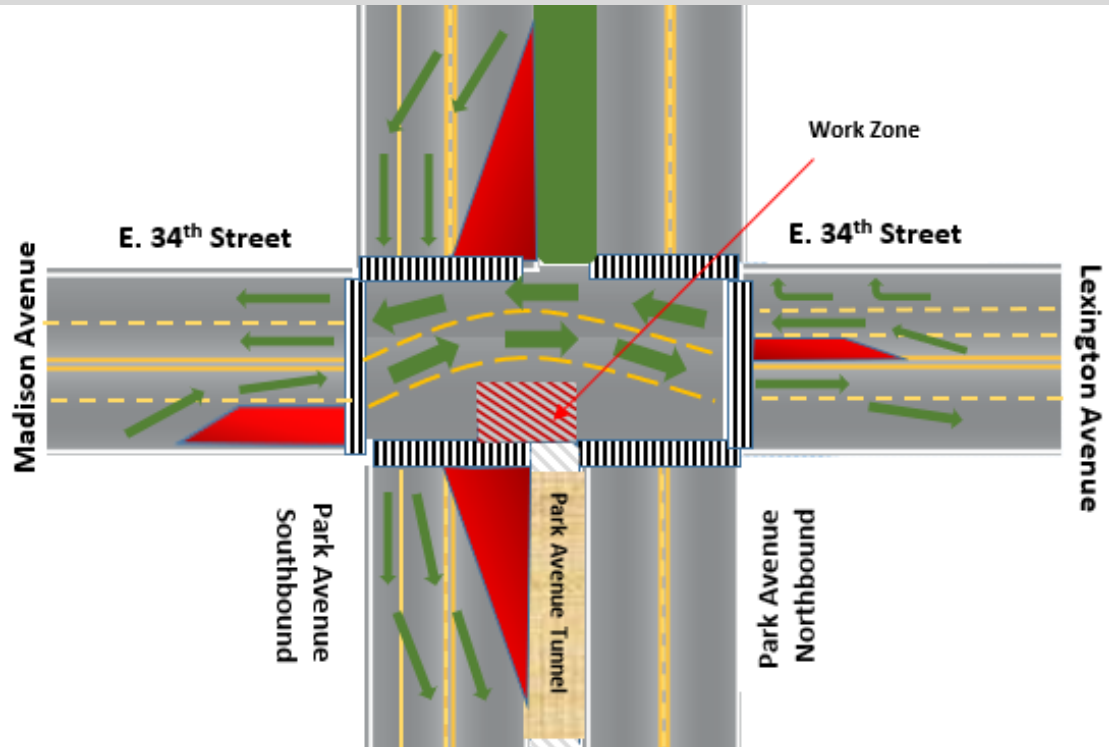

- Southbound Park Avenue - **Left** lane closure between E. 35th Street and E. 33rd Street
- Southbound Park Avenue - **Right** lane parking removed, No Standing Anytime
 - Eastbound **RIGHT** lane closure on 34th Street
 - Westbound **LEFT** lane closure on 34th Street

Patty Sarantakos from the LiRo Group is available to provide information about this project at (646) 476-0804 or parkavenuetunnel2016@gmail.com. For all NYC non-emergency services, including inquiries regarding NYCDOT construction projects, dial 311.